



Intuitive Specialists

Controlled Remote Viewing

Remote Viewing Summary Report

Session #3CTCCW 128011

What Lies Beneath Mount Shasta?

(c) Lori Williams May 2017

Prior to viewing this target, I was given the following information:

The target is a Location. Describe the Location.

Throughout this entire session, which took place over a period of 3 days, I never had a clue what the target was. My first impression was via the [Ideogram](#) was of very steep land, which was:

Rocky
Grey
Brown
Hilly
Slanted
Shadowed
 with shades of light and dark
 greys and oranges
Round
Small
Numerous
Partially lit
Scattered

(Monitor: Move up 50 feet and describe:)

Barren
Open
Dark



- (1)
- Rough
- Rocky
- Orange
- White
- Grey
- Shadowed
- Steep

(Monitor: Move an appropriate distance beneath the inclined land and describe:)

- Clinking sounds
- White
- Shiny
- Tunneled
- Square
- Concentric
- Pristine
- Well-planned
- Hidden

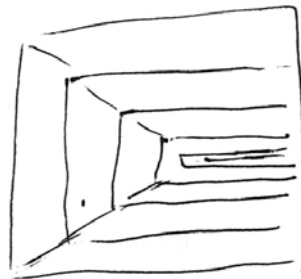

(Monitor: Move to the "clinking sounds" and describe)

(Lori: I am seeing that hilarious scene from Austin Powers when he is in a golf cart sort of thing, stuck horizontally in a narrow white underground hallway, bonking back and forth, trying to get turned around.)

Clinking Sound:

Mechanical

Up and down motion

Cylindrical

Shiny

Chrome-colored

Narrow

Purposes:

Functionality

Motion

Transportation

Heating

(Lori: This place was planned and built.)

(Monitor: Move to the builders and describe.)

Blue

Tall

Thin

Regal

Regimented

Disciplined

Walking in unison

Side by side

Male and Female

Quiet

Shuffling sounds

"Scouted" *(I had the feeling that only the cream of the crop is allowed here, and they are specially chosen to be a part of this.)*

"Cater-walling." *(I don't even really know what that means, but it came, so I wrote it down.)*

Deep underground

Scientific

Militaristic feel

There is a strange bio there...

Spoked. *(The hallways extended out from a central hub, like the spokes of a wheel):*

See illustration on Page 4

~militar

Spoked .

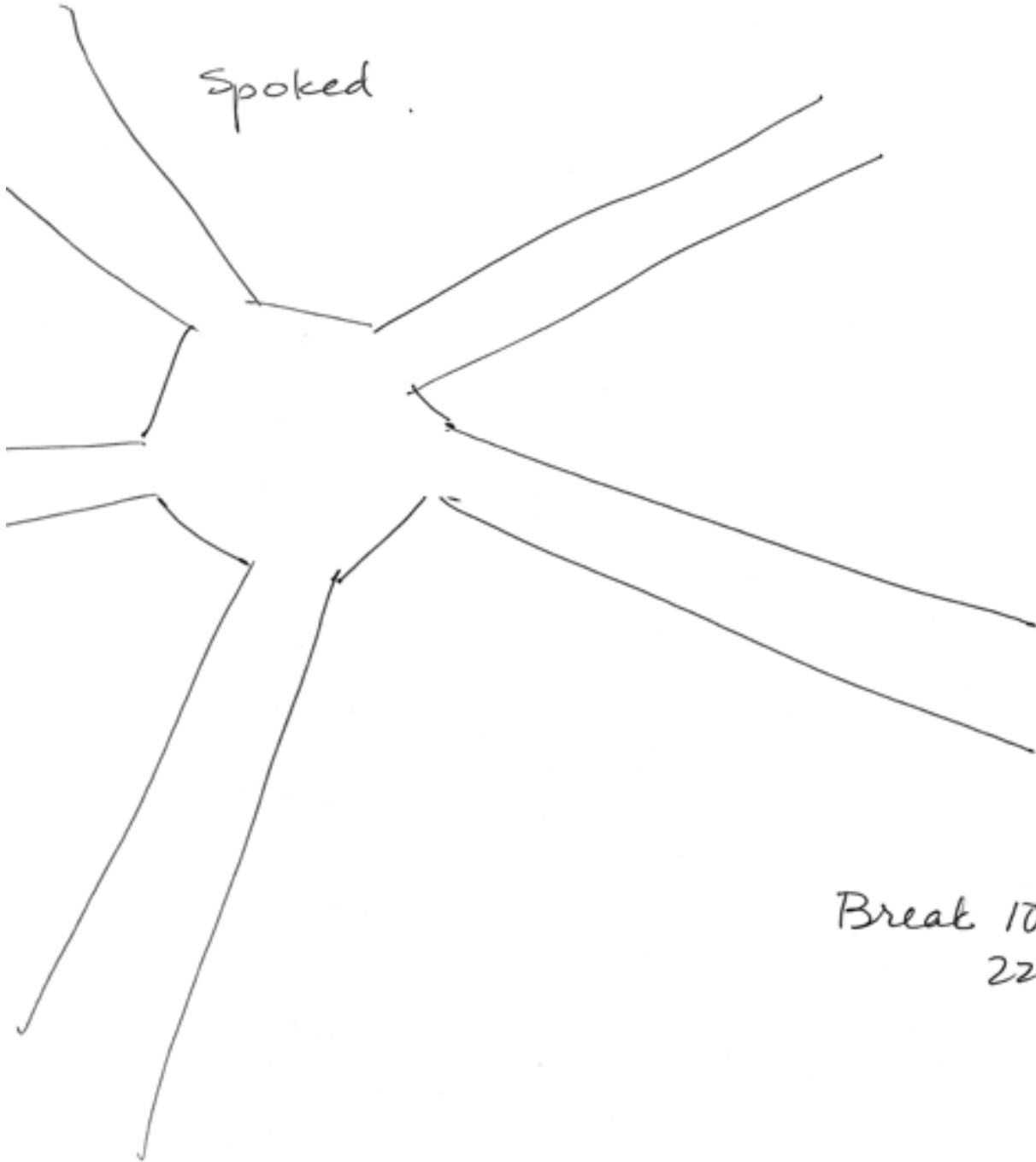

Break 10:
22:!

(Monitor asks, Move to the "strange bio" and describe.)

White
Dark haired
Male
Walking
Stoic
"There to do a job."
Vertically positioned
Thin
Focused
Single-minded
Intense

(Move to that which the bio is focused on and describe)

Military
Experimental
Scientific
"Out there" (as in strange or wild!)
Testing
Sadistic
Cruel

The biological being has been found to be:

Cold
Calculating
and to him, this all seems "normal" and "all in a day's work."

(Monitor: Move to the object of the experimentation and describe)

Helpless
Alone
Biological
Non Human
Yellow-orange color
Feels very sad
 Trapped
 Against its will
Hairy
Furry
Soft
Very large
Strange looking
Lonely

(Object of Experimentation, continued)

Misses its own kind

Sad

Solitary

One among few

It feels like a rare creature that is being experimented on and held in captivity against its will.

(Monitor: Move to the end result of the experiment and describe)

Dark

Fastidious

Cut short

Cataclysmic

No longer viable (It felt as though the creature had expired)

This seemed unexpected by the experimenter, who was surprised.

(Monitor: Move to the builders (laborers) of this place and describe)

Several

Male

Huge

Big

Dark-skinned

Large body build

Not very intelligent

(They seemed like "lumbering apes" to me)

Like slaves, overworked laborers.

(Monitor: Move to the mastermind behind the building of this place and describe.)

Astute

Wealthy

Very focused

Family linked

(At this point, I felt the need to summarize what I understood about the target thus far:)

All of this is part of a bigger plan. This is just a small piece, like a cog in a big machine. This place was constructed for a special use. Very secretive, polished, only the very select are allowed there. Cream of the crop scientists. The goal is so far out there, it is difficult to comprehend. It felt like some sort of "secret underground lair" to me. The purpose of this place is experimentation and exploitation. Everything there is "State of the Art."

(Monitor: Move to the most important bio there and describe:)

Powerful
Male
White
Caucasian
Older
Grey haired
Fastidious
Scientific
(A "Dr. Who" reference came to mind.)

(Monitor: Move to the plans and intentions of the bio and describe)

Colorful
Serious
Worldwide
(At this point, it all seemed very scary to me. To anyone involved there, it seemed:
All important
"Life mission"
All consuming
Worth giving his life for.
Involves mankind
Involves future of...
To gain power
To retain power
To guarantee future for himself and his family.

(Monitor: Move to the experimentation and describe):

(It felt scientific and "out there" in the way that CERN is scientific)

Scientific
Complex
Complicated
"Over my head."
Top secret
Well-guarded
Yellow
Human
Far reaching
Involving Mankind

(Monitor: Move to the "involving mankind" and describe):

Climate-related

(At this point, I decided to write a quick interim summary, to gather my thoughts about the target:)

The target involves a location that contains an underground element, which is hidden, and top secret and which involves experimentation that has to do with climate change and the future of the planet and mankind. The area is very mountainous.

This area is very mysterious and has small manmade airborne vehicles that come and go, back and forth, among the mountain tops. It feels as though this is a "fleet" of some sort. These are experimental vessels.

The location itself is:

Cold

Wet

Night time

Dark

Under cover of night

Run by top scientists

Used for security

Preserving...

Concepts of preservation

Future

Food, seeds, etc.

Preparation.

Quick sketch of overall area. The spoked area is underground. The mountains are above, and the craft are also visible as they come and go.

x INTRIGUED

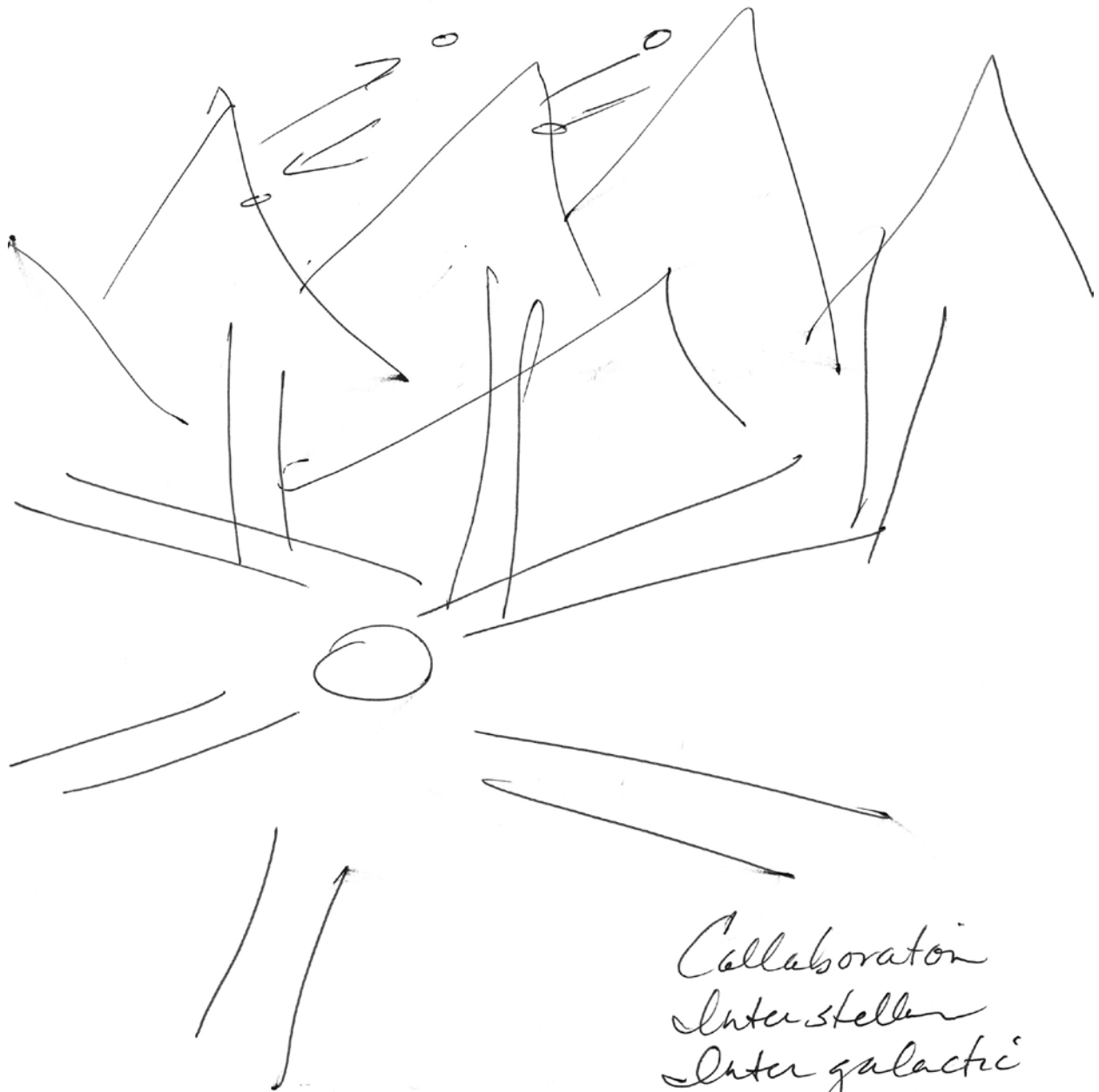

*Collaboration
Interstellar
Intergalactic
collaboration -*

Collaboration
Interstellar
Intergalactic
Collaboration

This area is used for

Study
Research
Protection
Preservation

It has an ambience which is

Mysterious
Futuristic

(Monitor: Move to the head bio and describe):

(I asked mentally, "Is this good or bad for Mankind?")

Depends on your perspective.

(I feel very uncomfortable at this point...)

Experimentation on human subjects.
Experimentation on plants.
Experimentation on seeds.
Experimentation with food.

Preparation for eventual possible survival in a post-apocalyptic scenario.

This is a "think tank" sort of place.
Very high-tech.
Assisted by higher intelligence
Funded by "big money" -- but this is not *about* Money.
This is about Power.

Again, there were concepts of:

Science
Experimentation
Preservation
Protection.

What are they protecting?

Status Quo
Power

It is not necessarily good for mankind overall.

(Monitor: Move to what they are protecting from and describe):

Threat to power
Any threat to status quo
Uprisings
"Awakening the Slaves." *(That was an odd phrase.)*

(Monitor: Move to the "awakening the slaves" and describe)

Radical
Courageous
Heart-Led
Spiritual
Down-to-Earth
Unafraid
Pure
"The Meek Shall Inherit the Earth"

(At this point, I thought of the YouTube video by Carl Sagan called [Pale Blue Dot](#))

Perspective
We are Eternal

(Monitor: Move to any actions we can take for self-preservation and describe):

Lori: I don't know...

(Monitor: What do the Powers that Be fear most?)

Unity
Solidarity
Rational Thinking
Fearlessness
Heart-Led People
Those who will not be silenced
Changes are coming...
All good things come to he who waits...
Embrace each day.
The Greatest Power is in Love
And *Their* greatest power is in Fear.

Session End.

Conclusion:

This was such a powerful, intense session for me, and there were several times that I was tempted to quit -- to not finish the session and certainly not to share it on the airwaves for millions to see. At the same time, the message seemed very important and very powerful. So I felt compelled to continue, not having any idea what I was seeing or why. I just knew it was an important message. It was fascinating and encouraging to discover that the mountain I remote viewed was Mt. Shasta.